



E SERIES

AIR CART SYSTEM

Welcome to the next generation of styling and productivity from SeedMaster. The new E Series wagon-style air carts feature a wide range of innovative elements designed to increase your seeding productivity, reduce maintenance, and give you greater control. At the heart of the new E Series carts is the electric drive metering system with an infinitely variable range allowing you to speed up and slow down depending on conditions and the rate of seed or fertilizer you require. Turn compensation and variable rate applications per section are now capable with the E Series Cart.



METER MAINTENANCE

That's almost a thing of the past with our new *patented* **CleanFlo** meter purge system. Positive air pressure is introduced to both sides of the meter housing, ensuring fine particles are unable to penetrate the meter rollers and cause wear and damage. Instead, fines continue to flow through the meter into the product distribution stream. The meter rollers essentially ride on a cushion of air, resulting in near-zero wear and exceptionally long service life.

The result is a distribution system that maximizes precision and efficiency, requiring only one size of meter for all bulk seeded crops and fertilizer applications. Additionally, the canola tanks will have dedicated fine canola roller meters.

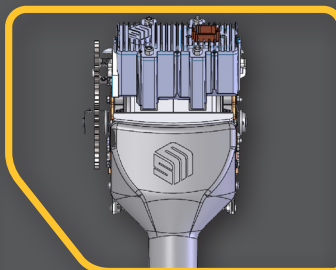
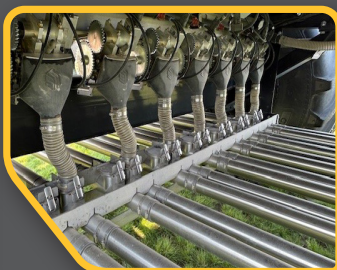
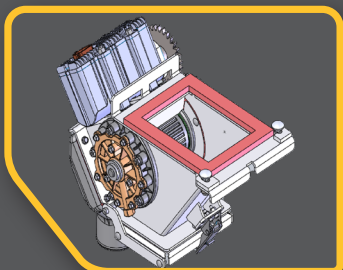

TANK SIZES

The E800 is a 3-tank tow-behind cart. The front and rear tanks are each 315 bushels while the middle tank is 170 bushels. This 3-tank configuration is ideally paired with the new UltraPro 3 on-frame tank with 80 bushel capacity, fully integrated with the E Series control system, for a total capacity of 880 bushels. All tanks are mounted on load cells.

The E860 is a 4-tank tow-behind cart. The splits are 315-170-315-60, with the rear 60 bushel tank dedicated to canola or fine products. All tanks are mounted on load cells.



EASE OF FILLING

Each of the E Series tanks have large tank openings to make it very easy to fill with a conveyor or mini-bulk.

Equip your E Series cart with an optional new KSI conveyor with wireless remote. The conveyor is exceptionally easy to operate with its long, low-angle design. The chevron belt ensures fast loading while the low-profile hopper makes placing under semi-trailers easy. The maneuverability of the conveyor is world-class, allowing it to be raised high above the cart railing to allow a semi-trailer to pull up alongside before lowering the conveyor quickly and easily into the loading position. In the event you have to unload the primary tanks, the KSI hopper will reach all three tanks for complete emptying.

Both the rear of the E Series cart and UltraPro 3 on-frame tank is available to equip with an optional remote-operated picker crane for loading mini bulk bags of seed or other products.



SINGLE SHOOT. DOUBLE SHOOT. TRIPLE SHOOT.

The 3 and 4 tank E Series carts are available in single and dual shoot configurations. Switching between seed and fertilizer distribution at the meter is easy and simple by using the quick-latch hose connectors on each stainless-steel distribution line. All distribution hardware on the E Series cart is stainless-steel for long wear life.

When equipped with an on-frame UltraPro 3, the toolbar can be setup for triple shoot with a dual shoot seed boot available.

Due to the all-new fully integrated control system, all new E Series carts will be required to pair with new SeedMaster toolbars (SMD, SMS, SMDi)



ENHANCED FEATURES

- + Wagon-style cart with front axle, TBH offered (TBT available at a later date)
- + E800 - 3-tank - 315-170-315 bu. splits
- + E860 - 4-tank - 315-170-315-60 bu. splits
- + Electric Meter Drives
 - Sectional control by 10 run sections
 - ie. An 8012 configuration will be 8 x 10 run sections at 10 feet wide
 - Up to 90 runs
 - Variable rate capabilities within the range of each meter per 10 run section
 - Turn compensation capable
- + 24-volt electrical system
 - Hydraulically-driven alternator for charging the batteries for a self-contained electrical system
- + CleanFlo - meter purge system
 - Near-zero meter maintenance and long wear life
 - Positive air pressure prevents fine particles from getting into the meter rollers
 - Fines flow through the meter into the product distribution stream
 - Meter rollers essentially ride on a cushion of air for near-zero wear
- + One meter roller for all bulk seeded crops and fertilizer applications, no changing of meter rollers
- + Seed canola with either 60 bu. rear mounted on-cart tank with bulk metering distribution or equip with an 80 bu. on-frame toolbar-mounted UltraPro 3 system for near-zero seed mortality and planter-like singulation
- + New KSI conveyor system with wireless remote
 - Long, low angle with chevron belt
 - Built in low-profile hopper
 - Exceptionally easy to use and maneuver
 - Tank weight readouts on wireless remote
- + Large tank lids for ease of filling
- + Load cells standard on each tank
- + Stainless Steel distribution hardware
- + Optional picker crane for loading mini bulk bags for E860

Pair your E Series 800 with a UP3 frame mounted tank for planter-like canola singulation and near-zero seed mortality.

- + 80 bu. capacity fully integrated with E Series Cart
- + Electric meter drives
- + Canola meter for each opener with a dedicated distribution line straight to the seed knife
- + Distributes up to 90 runs (up to 9012 toolbar)
- + Optional picker crane for loading mini bulk bags
- + Front-end loader accessible